

RESOLUTION No. 64-2023
Place-to-Place/Extension of Premise Transfer
Liquor License #1343-33-013-006
Shipmasters, Inc. t/a Eventide Grille at Navesink Marina

Councilmember Booker introduced and offered the following resolution for its adoption; seconded by Councilmember Bieber:

WHEREAS, an application has been filed for a Place-to-Place Transfer (Expansion of Premises) of Plenary Retail Consumption License Number 1343-33-013-006, issued to Shipmasters, Inc. t/a Eventide Grille at Navesink Marina, 1410 Ocean Avenue, Sea Bright, New Jersey, for the purpose of expanding the premises under license wherein the sale, service, and storage of alcoholic beverages are authorized; and

WHEREAS, the submitted application form is complete in all respects, all appropriate State and Borough transfer fees have been paid, and the license has been properly renewed for the current license term;

NOW, THEREFORE, BE IT RESOLVED that the Borough Council of the Borough of Sea Bright, County of Monmouth, State of New Jersey does hereby approve, effective April 4, 2023, the expansion of the aforesaid Plenary Retail Consumption licensed premises located at 1410 Ocean Avenue, Sea Bright, New Jersey, to place under license the area delineated in the application form and the sketch of the licensed premises attached thereto.

BE IT RESOLVED that a certified copy of this resolution shall be forwarded to the following:

1. Chief of Police
2. State of New Jersey, Division of ABC
3. Eventide Grille

Roll Call:	Bieber,	Booker,	Catalano,	Gorman,	Keeler,	Lamia
	Yes	Yes	Absent	Yes	Yes	Yes

April 4, 2023

CERTIFICATION

I, Christine Pfeiffer, Borough Clerk do hereby certify that the foregoing is a resolution adopted by the Borough Council of the Borough of Sea Bright, County of Monmouth, State of New Jersey, at a Council Meeting held on April 4, 2023.

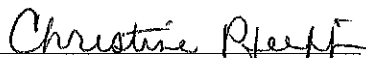
Christine Pfeiffer, Borough Clerk

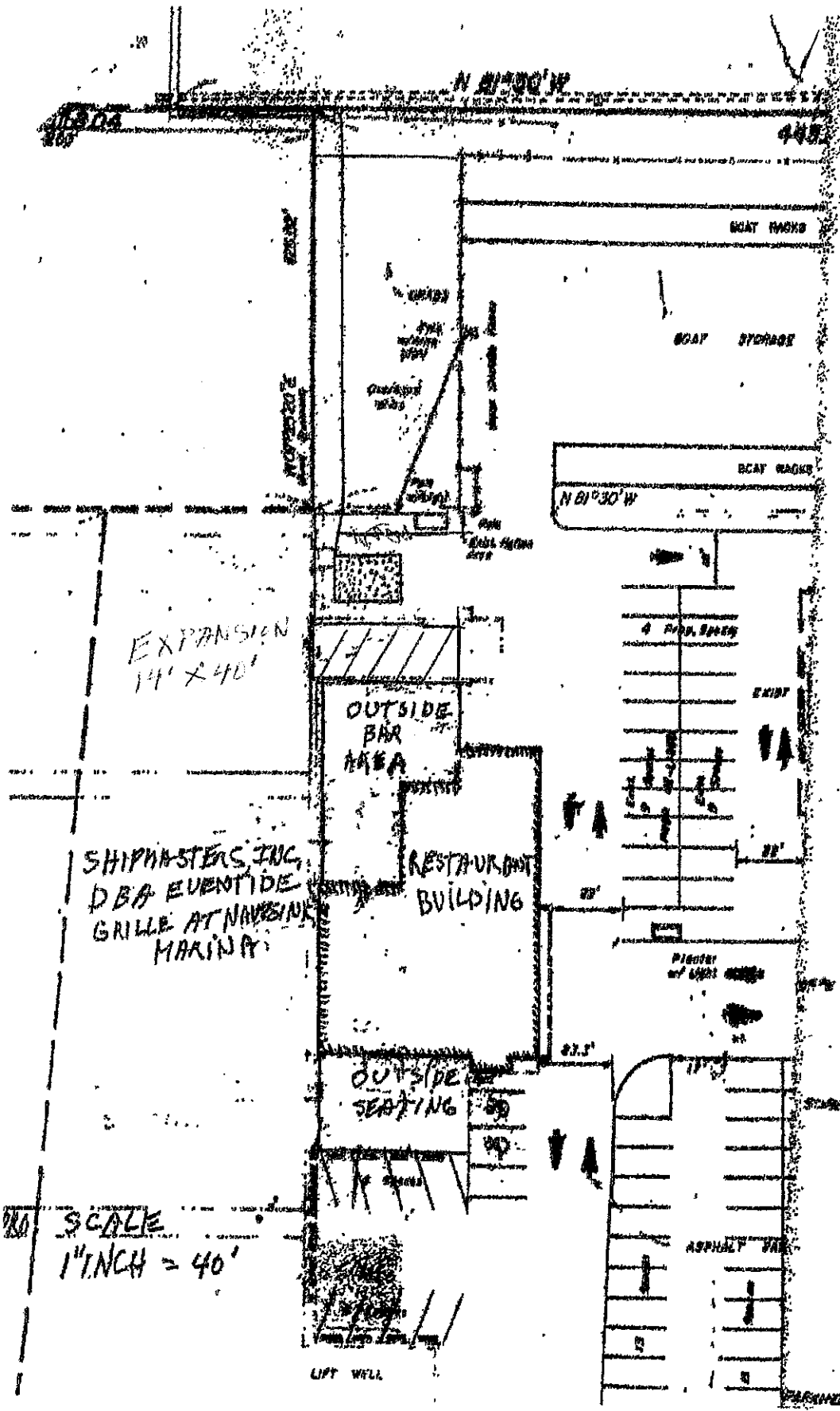

EXPANSION
14' x 40'

SHIPMASTERS INC.
DBA EVENTIDE
GRILLE AT NAVYSINK
MARINA

OUTSIDE
BAR
AREA

RESTAURANT
BUILDING

OUTSIDE
SEATING

SCALE
1" INCH = 40'

LIFT WELL

SEAT RACKS

SEAT STORAGE

SEAT RACKS

N 81°30' W

4 SEAT RACKS

EXIT

23'

PIECES OF LIGHT

As surveyed hereon 19...

STRUCTURE INFORMATION PREPARED

ASPHALT PAV.

PARKING

ShipMasters Inc.
TIA Fusion Building Co. Inc.

81743-013-005